

Installation Instructions – PM170

SL910 M-LIGHTZ

Classification: IC-F / IC-4

Recessed luminaire where approved fixed building insulation material that can be safely be continuously exposed to 90°C is allowed to abut and cover the luminaire.

Constant voltage:

11-30VDC

Approved insulation:

Pink Batts, Bradford Gold, InsulPro Polyester insulation, Ecofleece, Autex Greenstuf, Earthwool, Premier insulation.

Contact Switch Lighting for other insulation information.

Caution:

All cabling connections required to be fully waterproofed for exterior installation.

DO NOT use 12V or 24V AC drivers.

Note:

Reverse polarity protected to 60VDC.

IP67 front and rear.

White models suitable for interior use only.

Stainless steel, black or natural anodise models suitable for indoor or outdoor use.

Smaller cables may be used if operated from 24V power supply units.

Warranty:

Luminaire: 5 years (7 years if indoors)

Proof of purchase is required.

Warranty will be void if the product is immersed fully in water.

See website for full warranty conditions.

Please see overleaf for Constant Voltage information

www.switch-lighting.co.nz

Required clearance: Standard

Required clearance from structural members and building elements:

SCB = 0mm **HCB** = 0mm

Cut-out

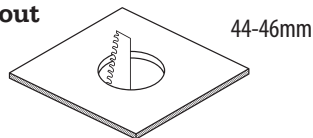

Installation:

(by registered electrician only)

1. Connect the lights in **PARALLEL**.
2. Ensure 12V or 24V DC power supply is adequately rated. Allow 4.2W per light.
3. Ensure cable is adequately rated.

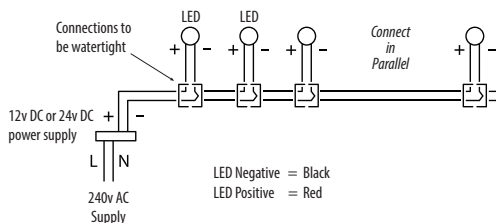
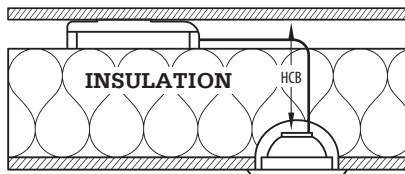

How many constant voltage lights per driver?

Use the convenient table below to check max & min number of lights to connect:

230V Constant voltage drivers					
Driver	Power max	V	Output	SL910	Dimmable
Q4-12V-20W	20W	12	12V@1.7A	1-4	No
SLDV-12V-40W	40W	12	12V@3.3A	1-8	No
SLDV-12V-75W	75W	12	12V@6.25A	1-15	No
SLDV-24V-75W	75W	24	24V@3.15A	1-15	No
SLDV-24V-150W	150W	24	24V@6.3A	1-28	No

For cable sizing information, please visit www.switch-lighting.co.nz / Library / Spec Sheets / LED Tips and Tricks / page 7-8.